

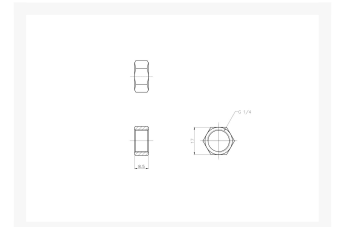

# Koolance- Fitting Coupling Adapter, Female- Female, Stainless Steel, G 1/4 BSPP

\$3.49

## Product Images



## Short Description

---

The Koolance Fitting Coupling Adapter provides a convenient coupler for converting between any two G 1/4 BSPP (parallel) thread fittings. Easily adapt any tubing diameter to another, for example, or a swiveling connection to a hose barb.

NOTE: Koolance G 1/4 BSPP (parallel) thread fittings are recommended for this product due to their short thread length (4mm). Other brands of G 1/4 BSPP fittings may need trimming to fit this product.

## Description

---

The Koolance Fitting Coupling Adapter provides a convenient coupler for converting between any two G 1/4 BSPP (parallel) thread fittings. Easily adapt any tubing diameter to another, for example, or a swiveling connection to a hose barb.

NOTE: Koolance G 1/4 BSPP (parallel) thread fittings are recommended for this product due to their short thread length (4mm). Other brands of G 1/4 BSPP fittings may need trimming to fit this product.

## Features

---

\*NOTE: Liquid Coolants Koolance's product warranty does not cover the use of 3rd-party coolants, coolant additives, or corrosion. Koolance LIQ-702 or LIQ-705 coolants are strongly recommended to help avoid issues with mixed metals or biological growth. Additionally, do not use aluminum with bare (unplated) copper or bare (unplated) brass in the same system. Do not use silver with nickel in the same system.\*

## Specifications

---

Weight	0.03 lb (0.01 kg)
Materials	SUS 316, EPDM
Max Pressure @ 25°C	15kgf/cm <sup>2</sup> (213.4psi)
Max Temperature	120°C (248°F)

## Additional Information

---

Brand	Koolance
SKU	ADT-XFF-SS
Weight	0.1000
Special Order	No
Fitting Type	Coupler
Fitting Size	1/4"
Fitting Angle	Straight
Fitting Finish	Chrome
Vendor SKU/EAN	829596910582

