

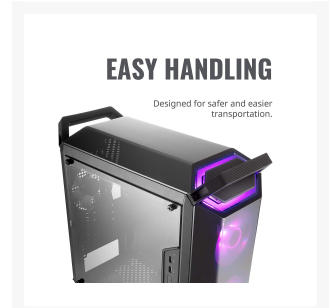

Cooler Master MasterBox Q300P

\$84.99

Product Images





Edge-to-edge acrylic side panel.

Two pre-installed 120mm RGB LED fans behind the front panel.



Case does not include full-system build or two top 120mm fans.



Case does not include two top 120mm fans.



Case does not include full-system build or two top 120mm fans.



Case does not include full-system build or two top 120mm fans.



Short Description

The MasterBox Q300P is your portable option in the MasterBox Q-series from Cooler Master, a series that might be small in size but excels in functionality, modularity, and thermal performance.

Description

The MasterBox Q300P is your portable option in the MasterBox Q-series from Cooler Master, a series that might be small in size but excels in functionality, modularity, and thermal performance.

Four removable handles and the DarkMirror front and top panels makes the chassis easy to transport and stands out from the rest.

The combination of a practical design and the unique customizable aesthetic makes the Q300P the perfect choice for gamers and creative builders.

Features

RGB Lighting

Use the RGB lighting to create a captivating build in your preferred color theme with the included RGB controller.

Easy To Handle

Four removable handles make it easy to transport or carry your full system build to a LAN Party.

Modular I/O Panel

The I/O panel can be adjusted to six different locations. On both side of the body you can install the I/O panel at the front, top or bottom.

Multiple Positioning Options

The case can be put in vertical and horizontal position.

Edge-To-Edge Side Panel

Show off your build through the full size transparent side panel.

Clean Routing Space

Behind the motherboard tray, it offers 28mm wide and spacy room for hidden cable management.

Specifications

Dimensions – L x W x H	450 x 230 x 450 mm (17.7 x 9.1 x 17.7 in)
Motherboard Support	Micro-ATX, Mini-ITX
Liquid Cooling Support – Front, Rear	1 x 120 mm / 1 x 240 mm, 1 x 120 mm
Materials	Steel, Plastic
Fan Support – Front, Top, Rear, Bottom	2 x 120 / 140 mm, 2 x 120 mm, 1 x 120 mm, 1 x 120 mm
Drive Bay Support – 5.25", 3.5" HDD, 2.5" SSD	0, 1, 2

Extra Features	RGB LED Control and 1-to-3 Splitter Cable Included, Four Removable Handles
Power Supply Support	Bottom Mount, ATX PS2
Clearances - VGA, CPU, PSU	360 mm, 157 mm, 160 mm (14.2 in, 6.2 in, 6.3 in)
I/O	2 x USB 3.0, Audio I/O

Additional Information

Brand	Cooler Master
SKU	MCB-Q300P-KANN-S02
Weight	28.0000
Color	Black
Chassis Form Factor	Mid-Tower
Side Panel	Window
Material	Steel
PSU Wattage	No PSU
Vendor SKU/EAN	4719512065518

