

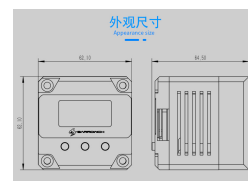

Barrowch 17W PWM Intelligent Waterway Board Pump, OLED Digital Display, Only For Barrow Waterway Boards - Matte Silver

\$93.50

Product Images



Short Description

These Barrowch Pumps are meant to be connected with the Barrow Waterway plates and include a integrated OLED Display and intelligent protection switch 'Auto' turn on protection mode, when the fault stops working it will control the computer to shut down, prevent overheating and protecting the hardware, pump cover and full cover aluminum alloy shell. They have a max flow of 960 L/H.

Description

These Barrowch Pumps are meant to be connected with the Barrow Waterway plates and include a integrated OLED Display and intelligent protection switch 'Auto' turn on protection mode, when the fault stops working it will control the computer to shut down, prevent overheating and protecting the hardware, pump cover and full cover aluminum alloy shell. They have a max flow of 960 L/H.

Features

17W PWM PUMP

INTELLIGENT EDITION

Integrated OLED display and intelligent protection switch 'Auto'

Turn on protection mode, when the fault stops working,
it will control the computer to shut down, prevent overheating, protect the hardware

PWM SPEED CONTROL 17W PUMP INTELLIGENT EDITION



FRSP17B-T



OLED display



Push-button
control



Aluminum alloy
cooling



Transparent
acrylic



17w pump



Integrated speed real-time detection





Ventilation and heat dissipation grilles



CNC Machining of Aluminum Alloy



Aluminum alloy heat sink cover, CNC machining, anodizing process
Keep the color unchanged for a long time,

Barrow LRC 2.0 lighting system, 5v 3pin
Compatible with some motherboards 5v programmable lighting interface



Static



Breathe



Rainbow



Gradient



Cycle



Double flash



wave



Flicker



Strobe



Shut down



Multifunctional Interface

Equipped with a variety of interfaces



D-type power supply interface

PWM interface/Speed detection

PC power switch jumper female interface

PC power switch jumper male interface

Lighting strip power supply interface

D-type power supply interface (2): Connect to PC power supply

PWM interface/Speed detection (3): Connect to the motherboard 'FAN' interface (7)

PC power switch jumper female interface (4): Connect to the motherboard power switch jumper socket (6)

PC power switch jumper male interface (5): Connect to case power switch jumper

Lighting strip power supply interface: Connect to the Barrow LRC2.0 lighting system,

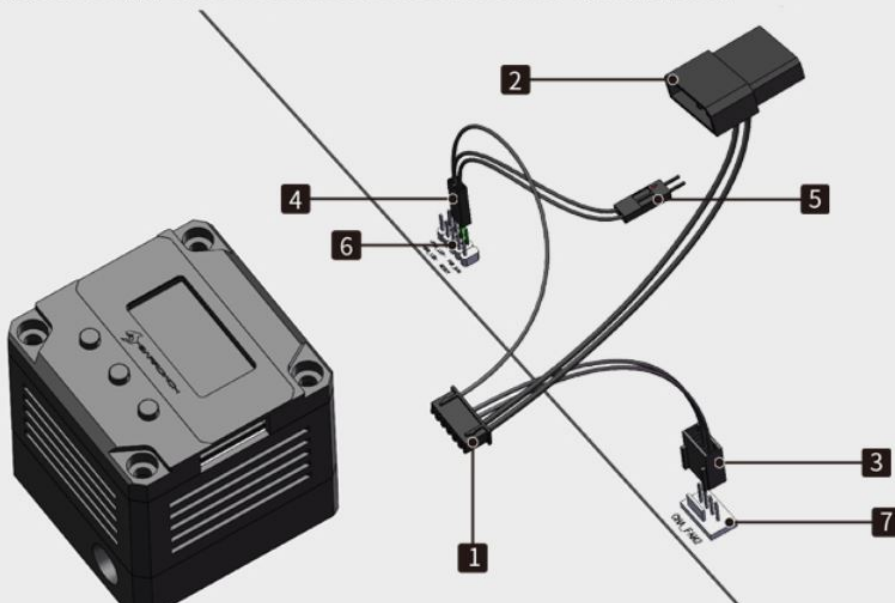

Product parameters

Rated voltage:	DC 12V	Temperature range:	<60 °C
Rated current:	1.4 A	Working noise:	<40 dB
Rated power:	17 W	Size:	63*63*63 mm
Maximum lift:	5-6 M	Rotating speed:	4000 PRM
Maximum flow:	960 L/H	Life:	>50000H
Interface:	G 1/4		

Purchase information

购买须知

1. Adjust freely direction of pump inlet and outlet, factory default is in the left of display screen, players can adjust as demand;
2. If you want to realize the intelligent shut-off function, it need to connect the motherboard switch jumper wire and fans interface;
3. Control type: LRC2.0 RGB lighting control type with aurora;
4. The standard does not contain controller. If need, please purchase it separately;
5. In case product appearance upgrade, without further notice, prevail in kind.

Additional Information

Brand	Barrowch
SKU	FBSP17B-T-MS
Weight	1.2500
Color	Silver
Pump Type	DDC PWM
Pump Voltage	12 VDC
Vendor SKU/EAN	6937826663321

