

# EK-Quantum Inertia D5 PWM D-RGB - Plexi

\$170.99

## Product Images

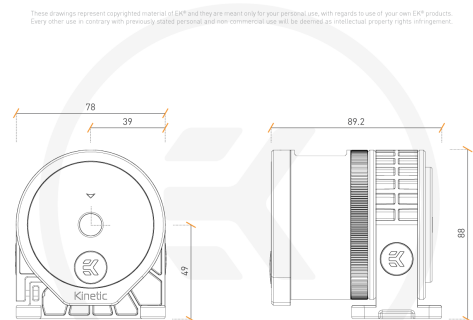
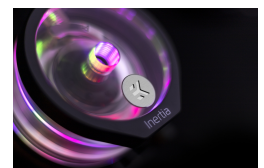
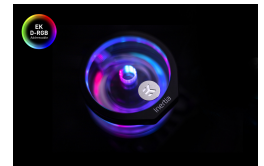

TOP VIEW, SIDE VIEW

## Short Description

---

EK-Quantum Inertia D5 PWM D-RGB is a high-performance liquid cooling standalone pump, built around the market-proven [Genuine D5](#) water pump and the new Quantum Inertia top with an advanced vibration-reducing mounting clamp. This unit offers increased hydraulic performance (up to 15%) compared to the original factory top and it comes with a pre-installed 3-pin 5V D-RGB LED strip for sophisticated illumination. This pump features a single inlet (on the top) and a single outlet port (on the side) for the installation of two standard G1/4 threaded fittings/barbs.

## Description

---

EK-Quantum Inertia D5 PWM D-RGB is a high-performance liquid cooling standalone pump, built around the market-proven [Genuine D5](#) water pump and the new Quantum Inertia top with an advanced vibration-reducing mounting clamp. This unit offers increased hydraulic performance (up to 15%) compared to the original factory top and it comes with a pre-installed 3-pin 5V D-RGB LED strip for sophisticated illumination. This pump features a single inlet (on the top) and a single outlet port (on the side) for the installation of two standard G1/4 threaded fittings/barbs.



The top is made of quality CNC-machined cast acrylic material with a black ring to cover the LED hotspots as the proper LED implementation is one of the main focus points of EK.

This pump is ideal for PC and other electronics water cooling. The D5 pump is equipped with an electronically commutated spherical motor. In a pump with a spherical motor, the only moving part is a spherically shaped rotor which in this pump is held in place by a bearing ball made of ultra-hard and wear-resistant ceramic. It is rated for 50.000 hrs MTBF at 25°C ambient!



MYSTIC  
LIGHT



This product is compatible with popular RGB sync technologies from all major motherboard

manufacturers. The arrow marking on the 3-pin addressable LED connector is to be aligned with the +5V marking on the D-RGB(A-RGB) header. You can easily remove the LED strip cover which is mounted with two screws to replace the LED strip with some other type LED strip.

## Specifications

---

Technical specifications:

- Motor: Electronically commuted spherical motor
- Rated voltage: 12V DC
- Power consumption: 23W
- Maximum pressure head: 3.9m
- Maximum flow: 1500L/h
- Maximum system temperature: 60°C
- Materials: Stainless steel, PPS-GF40, EPDM O-rings, Aluminium oxide, hard coal
- Power connector: SATA power and 4-Pin PWM FAN connector 50cm cable length
- Signal cable: 4-Pin PWM FAN connector 60cm cable length
- D-RGB cable length: 50cm
- D-RGB connector standard 3-pin (+5V, Data, Blocked, Ground)

Operational regime:

- PWM duty cycle: ~ 20-100%
- Default behavior: Runs at 100% duty cycle when no PWM feedback signal is present

Enclosed:

- EK-Quantum Inertia D5 PWM D-RGB (incl. EK-D5 PWM G3 pump motor) - cables with a black sleeve
- EK-Quantum Inertia D5 PWM D-RGB Pump Mount
- Self-adhesive mounting hole pattern sticker
- Mounting mechanism (incl. required Allen keys)
- EK-Loop Multi Allen Key (6mm, 8mm, 9mm)

Made in Slovenia - EU

Pump motor made in Hungary - EU

## Additional Information

Brand	EK Waterblocks
SKU	EK-INERTIA-D5-PWM-D-RGB-PL
Weight	2.0000
Color	Clear
Pump Type	Laing D5 PWM
Pump Voltage	12-24VDC
Vendor SKU/EAN	3831109821930

