

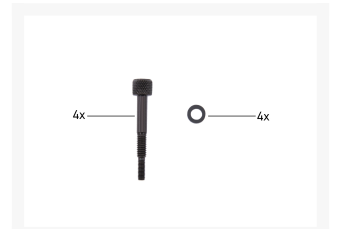

# Alphacool Backplate with Screws LGA 115x/1200/1700

\$6.95

## Product Images

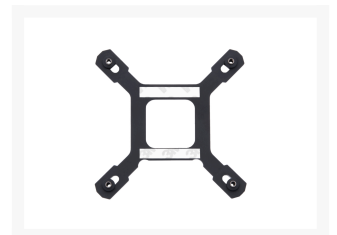

## Short Description

The Alphacool synthetic backplate for XPX, XPX Aurora, XPX Aurora Edge, XPX 1U, XPX Pro 1U, XPX Pro Aurora, Eisbaer, Eisbaer Aurora, Eisbaer Pro, Eisbaer LT is compatible with Intel's LGA 115X, 1200 and 1700 sockets. This includes solo water coolers and CPU AIOs. The backplate stabilises the CPU cooler on the socket and ensures optimum contact pressure. There is an additional adhesive surface on the back of the backplate that serves as an installation aid and thus makes mounting much easier.

## Description

---

The Alphacool synthetic backplate for XPX, XPX Aurora, XPX Aurora Edge, XPX 1U, XPX Pro 1U, XPX Pro Aurora, Eisbaer, Eisbaer Aurora, Eisbaer Pro, Eisbaer LT is compatible with Intel's LGA 115X, 1200 and 1700 sockets. This includes solo water coolers and CPU AIOs. The backplate stabilises the CPU cooler on the socket and ensures optimum contact pressure. There is an additional adhesive surface on the back of the backplate that serves as an installation aid and thus makes mounting much easier.

## Specifications

---

Compatibility:

Intel: LGA 1150 / 1151 / 1155 / 1200 / 1700

## Additional Information

Brand	Alphacool
SKU	AC-13064
Weight	0.2000
Color	Black
Block Accessory Type	Mount Bracket
CPU Series	Intel LGA 1150 / 1151 / 1155 / 1200 / 1700
Block CPU Type	Intel
Vendor SKU/EAN	4250197125673

